

ARMOUR BAR FITTING INSTRUCTIONS TO SUIT Mitsubishi MQ - MR Triton Dual Cab 2015+

Check contents of kit before commencing fitment and report any discrepancies

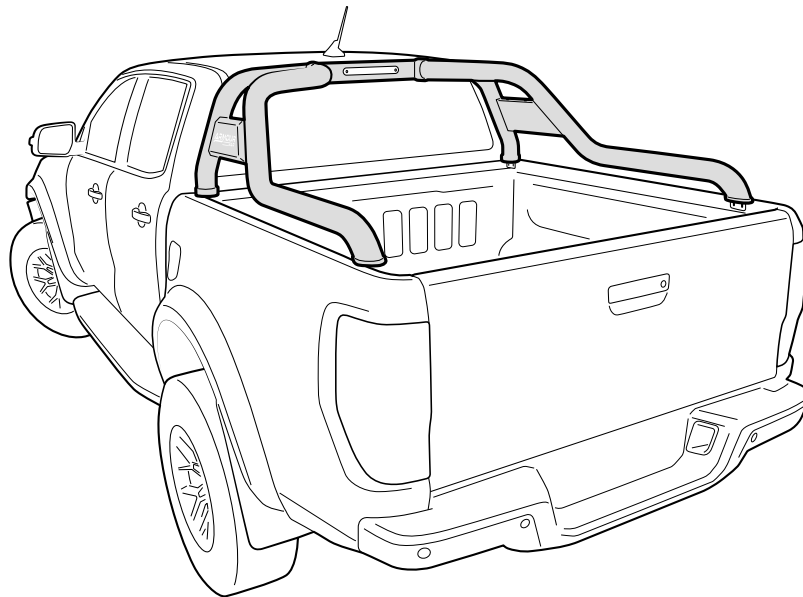

*Image example shown only

IMPORTANT	<ul style="list-style-type: none"> • Do not stand/sit or rest heavy objects on Armour bar. • Do not strap objects to the Armour bar. 			
Care Instructions	<ul style="list-style-type: none"> • Read Instructions fully before commencing installation. • Clean Armour bar with a mild detergent and water solution • Do not use abrasive cleaners or solvents • Refer to manufactures instructions applicable to power drill. • Protect Tub & tub floor against scratches during installation process. 			
Maintenance	<p>Check all fasteners regularly to make sure they are torqued up.</p>			
Tools Required	<table style="width: 100%; border: none;"> <tr> <td style="vertical-align: top; width: 33%;"> <ul style="list-style-type: none"> • Pen / Marker • Centre Punch • Drill & Drill bits </td> <td style="vertical-align: top; width: 33%;"> <ul style="list-style-type: none"> • Masking Tape • Spanner & Socket • Tape measure </td> <td style="vertical-align: top; width: 33%;"> <ul style="list-style-type: none"> • Soapy water solution • Allen Key set (Metric) • Test light </td> </tr> </table>	<ul style="list-style-type: none"> • Pen / Marker • Centre Punch • Drill & Drill bits 	<ul style="list-style-type: none"> • Masking Tape • Spanner & Socket • Tape measure 	<ul style="list-style-type: none"> • Soapy water solution • Allen Key set (Metric) • Test light
<ul style="list-style-type: none"> • Pen / Marker • Centre Punch • Drill & Drill bits 	<ul style="list-style-type: none"> • Masking Tape • Spanner & Socket • Tape measure 	<ul style="list-style-type: none"> • Soapy water solution • Allen Key set (Metric) • Test light 		

PARTS CHECK SHEET

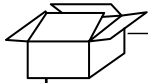

PARTS IN MAIN CARTON

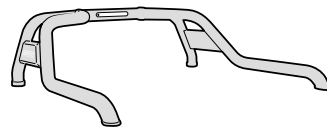

Armour Bar

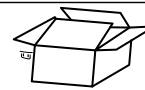

Fitting Kit
Qty - 1

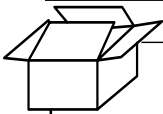

PARTS IN FITTING KIT

20040940001



FRONT TUBE ASSEMBLY

Qty - 1

20044665301



SIDE TUBE(L)

Qty - 1

20044665401



SIDE TUBE(R)

Qty - 1

20043603801



SIDE PLATE ASSEMBLY(L)

Qty - 1

20043604401

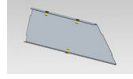

BACK COVER FOR SIDE PLATE(L)

Qty - 1

20043604001



SIDE PLATE ASSEMBLY(R)

Qty - 1

20043604501

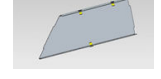

BACK COVER FOR SIDE PLATE(R)

Qty - 1

20044718801



MOUNTING BRACKET(L)

Qty - 2

20042554101



MOUNTING BRACKET(R)

Qty - 2

20008912301



JOINT RUBBERCOVER(L)

Qty - 1

20009589301



JOINT RUBBERCOVER(R)

Qty - 1

20008160801



HOLE PLUG

Qty - 2

20007045301

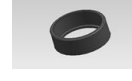

FRONT RUBBER FOOTING

Qty - 2

20042379701



REAR RUBBER FOOTING

Qty - 2

20042554201



ROLL R COVER BRACKET

Qty - 4

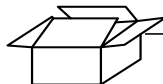

LID NUTS AND BOLTS

3005581



M10 x 60 ALLEN Head Bolt

Qty - 2

E3000145



M8 SPRING WASHER

Qty - 8

E3000233



M6 LARGE WASHER

Qty - 14

E3008096



M8 FLAT WASHER

Qty - 8

E3000325



M10 FLAT WASHER

Qty - 2

E3008067



M8 FLANGE NUT

Qty - 8

E3008066



M6 FLANGE NUT

Qty - 8

E3008107



M10 SPRING WASHER

Qty - 2

E3008109

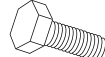

M6 HEX BOLT

Qty - 8

E3008155

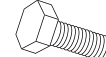

M8 HEX BOLT

Qty - 8

E3008097



M8 HEX FLANGE BOLT

Qty - 8

E3005469



M6 x 20 ALLEN Head Bolt

Qty - 6

E3008196



M6 SPRING WASHER

Qty - 6

E3008241



M8 x 30 ALLEN Head Bolt

Qty - 4

E3008235



M8 X 16.5 RIVET NUT

Qty - 8



OTHER

3000062



S4 ALLEN KEY

Qty - 1

3000078



S6 ALLEN KEY

Qty - 1



Fitting Instructions

Qty - 1

Thoroughly clean installation areas.

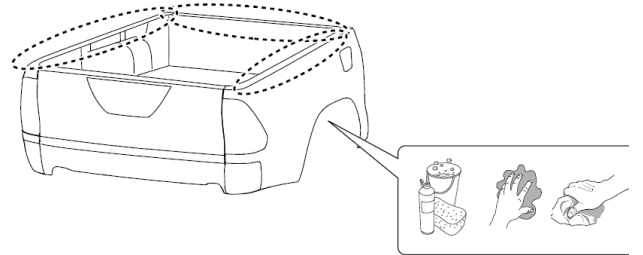

Place part number 20009589301 (JOINT RUBBERCOVER(R))
to 20040940001 (FRONT TUBE ASSEMBLY),
Repeat to the other side using part number 20008912301

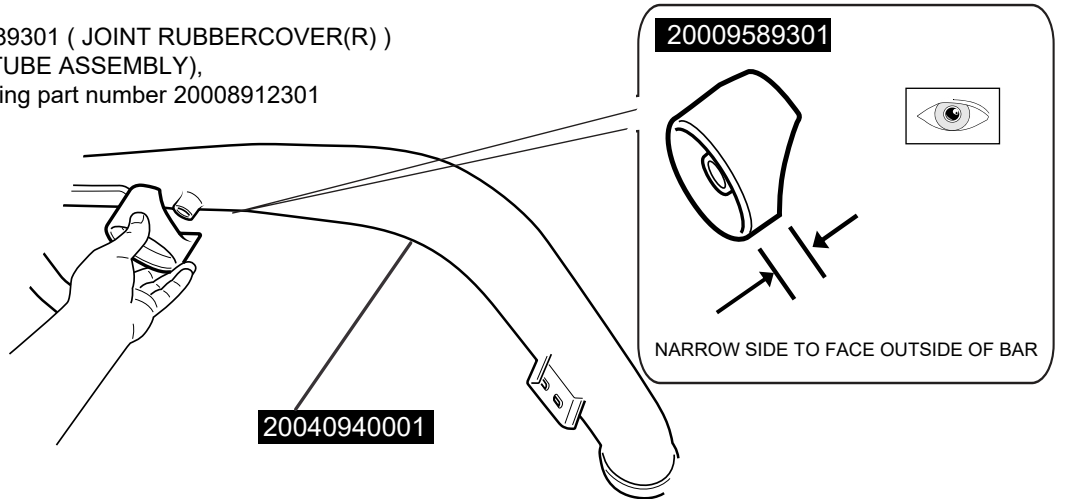

Feed into place part number 20044665401 (SIDE TUBE(R)) through
20009589301 and 20040940001.
Repeat to the other side using part number 20044665301 (SIDE TUBE(L))

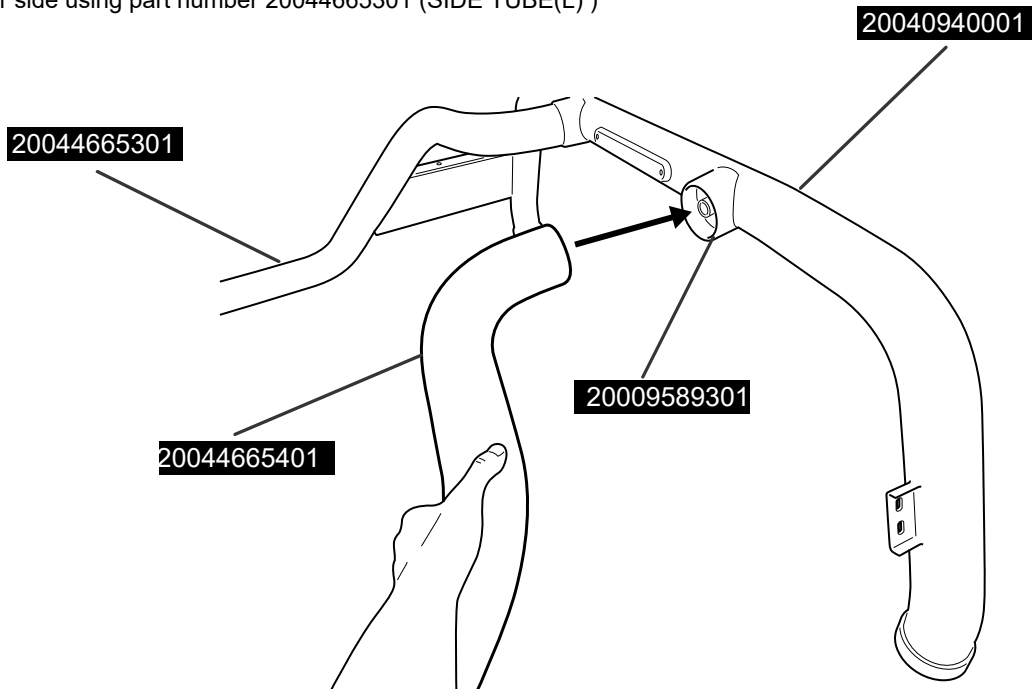

Feed part number 3005581 (M10 Allen head bolt) through E3008107 (M10 spring washer) , E3000325 (M10 washer), 20040940001 (Front tube assembly) and fasten to 20044665401 (SIDE TUBE(R)). Repeat to the other side.

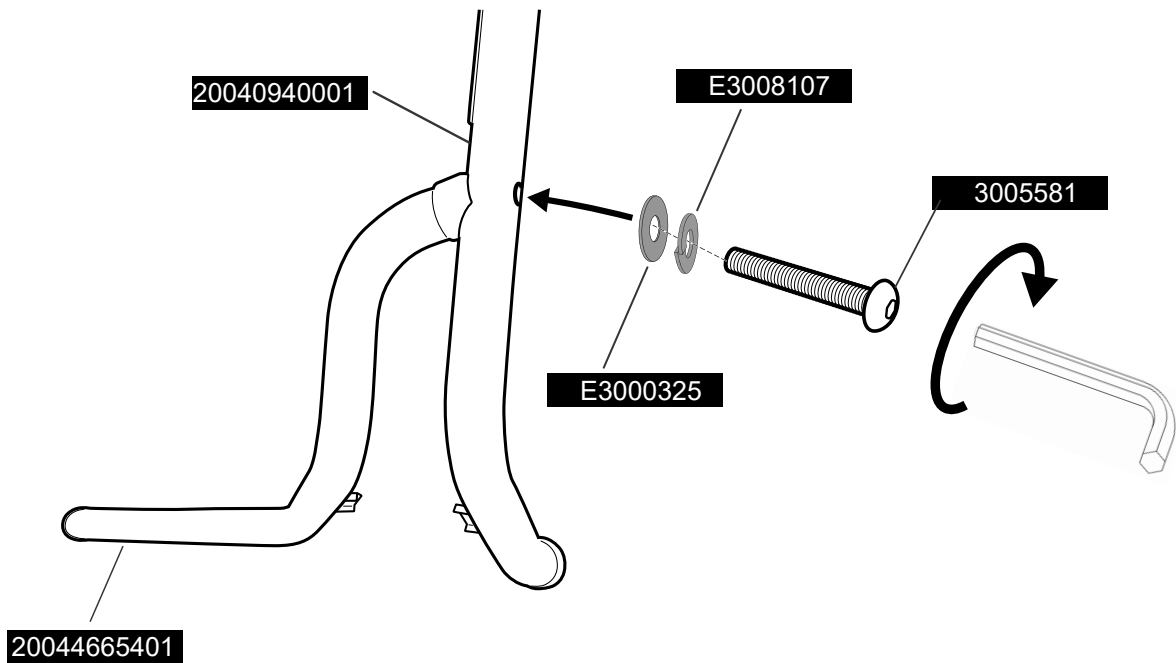

Align part number 20043604001 (side plate assembly (R)) as indicated.

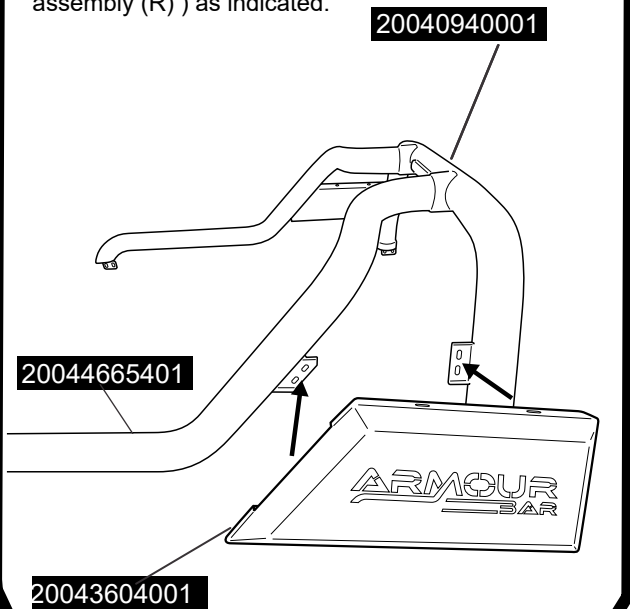

Fasten into position using, M6 Hex Flange bolt trough M6 large washer, the tube tabs, side plate tabs, & M6 Flange nut. Repeat to all 4 points.

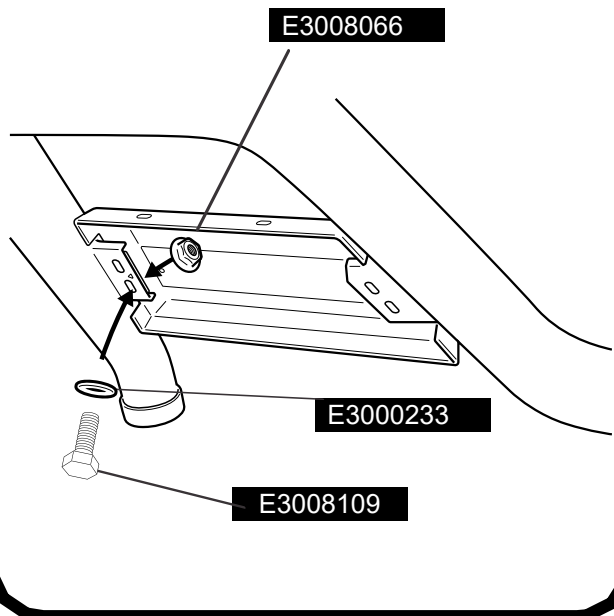

Repeat above steps to the other side using part number 20043603801 (side plate assembly (L))

Align part number 20043604501 (back cover for side plate (R)) as indicated.

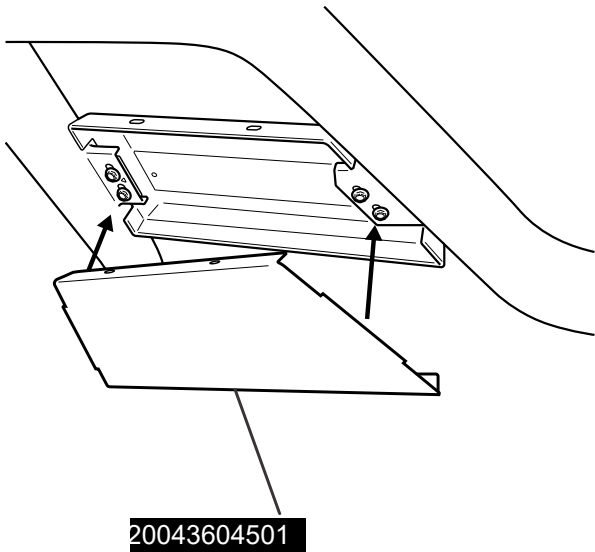

Fasten into position using M6x20 Allen head bolt through M6 spring washer and M6 large washer.

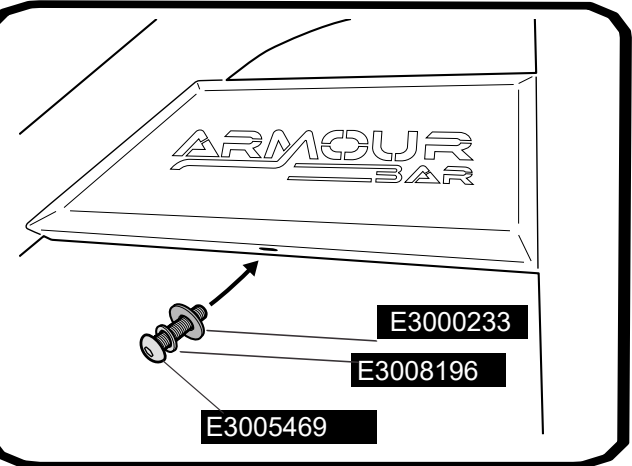
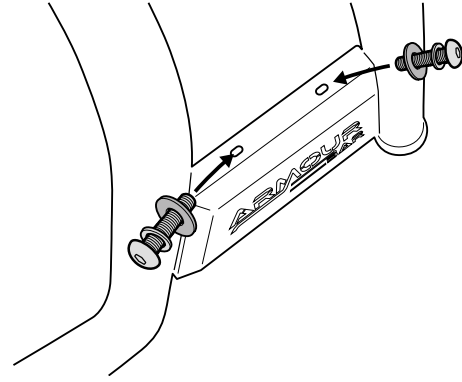

Repeat above steps to the other side using part number 20043604401 (back cover for side plate L))

Push in to position part number 20008160801 (hole plug) as indicated.
Repeat to the other side.

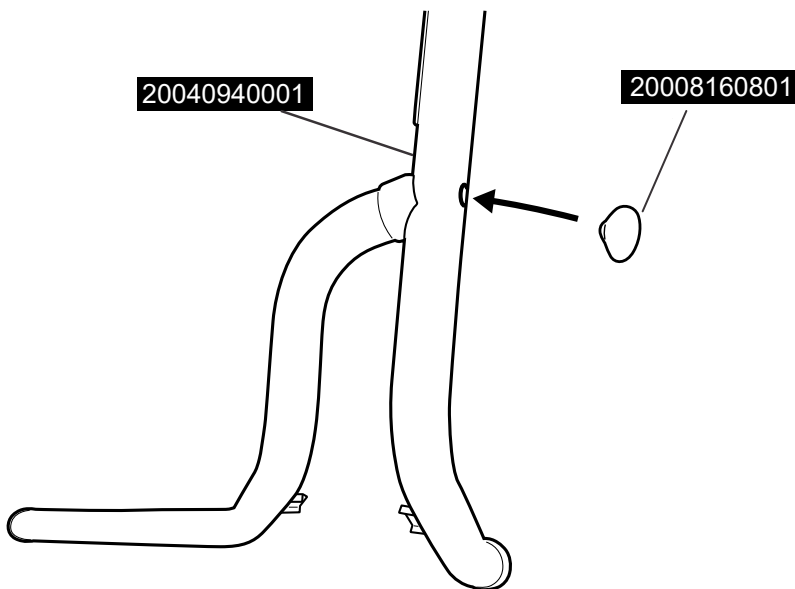

Using part number 20007045301 slide over front tube of Armour bar.

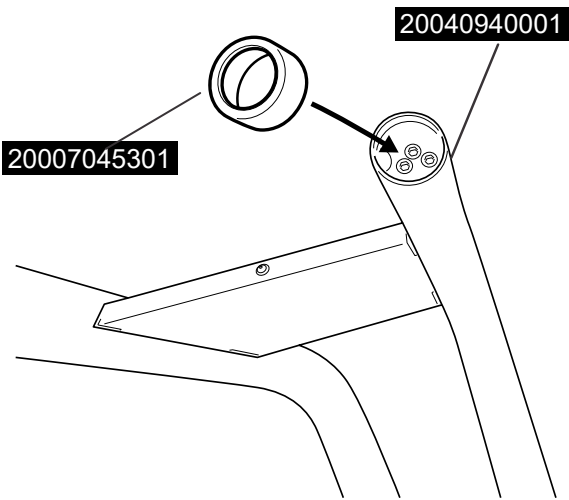

Using part number 20042379701 slide over rear tube of Armour bar.

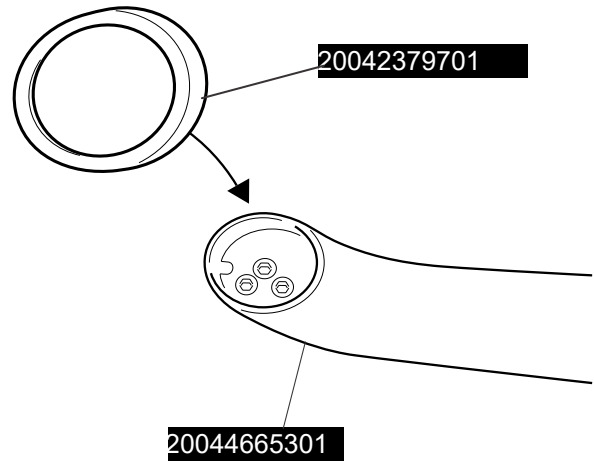

Repeat above steps to the other side using part number 20007045301 & 20042379701

1. Align part number 20044718901 (mounting bracket (R)) as indicated.
2. Fasten in to position using M8 x 25mm hex bolt, M8 spring washer and M8 flat washer.

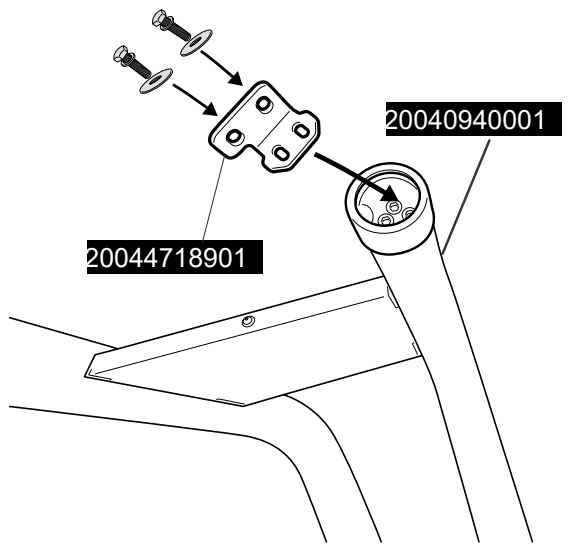

Repeat above steps to the other side. Using part number: 20044718801 (mounting bracket (L))

1. Align part number 20044718801 (mounting bracket (L)) as indicated.
2. Fasten in to position using M8 x 25mm hex bolt, M8 spring washer and M8 flat washer.

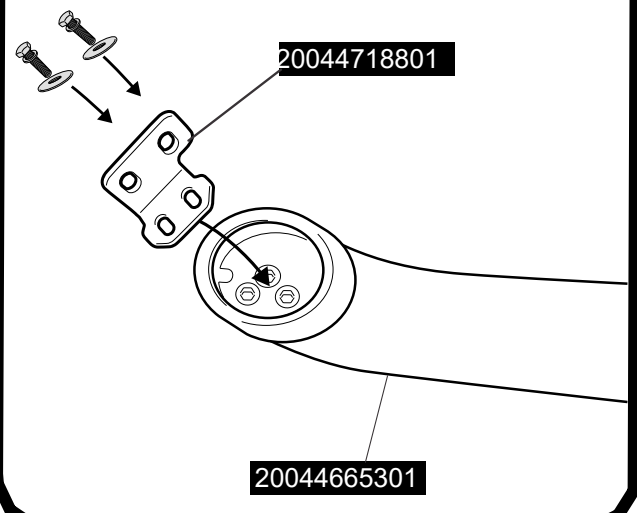

Repeat above steps to the other side. Using part number: 20044718901 (mounting bracket (R))

Place Armour bar on the tub rail.

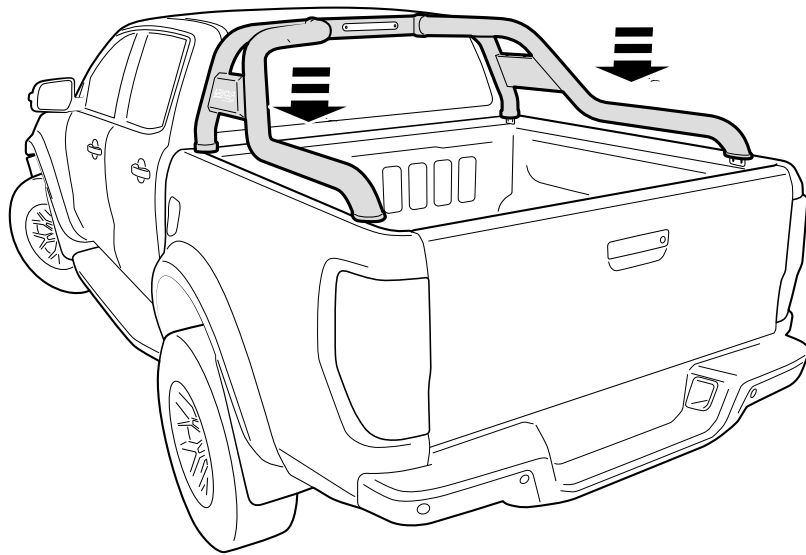

Measure back from inside of headboard towards the tailgate 30mm and center to the front hole of the bracket.

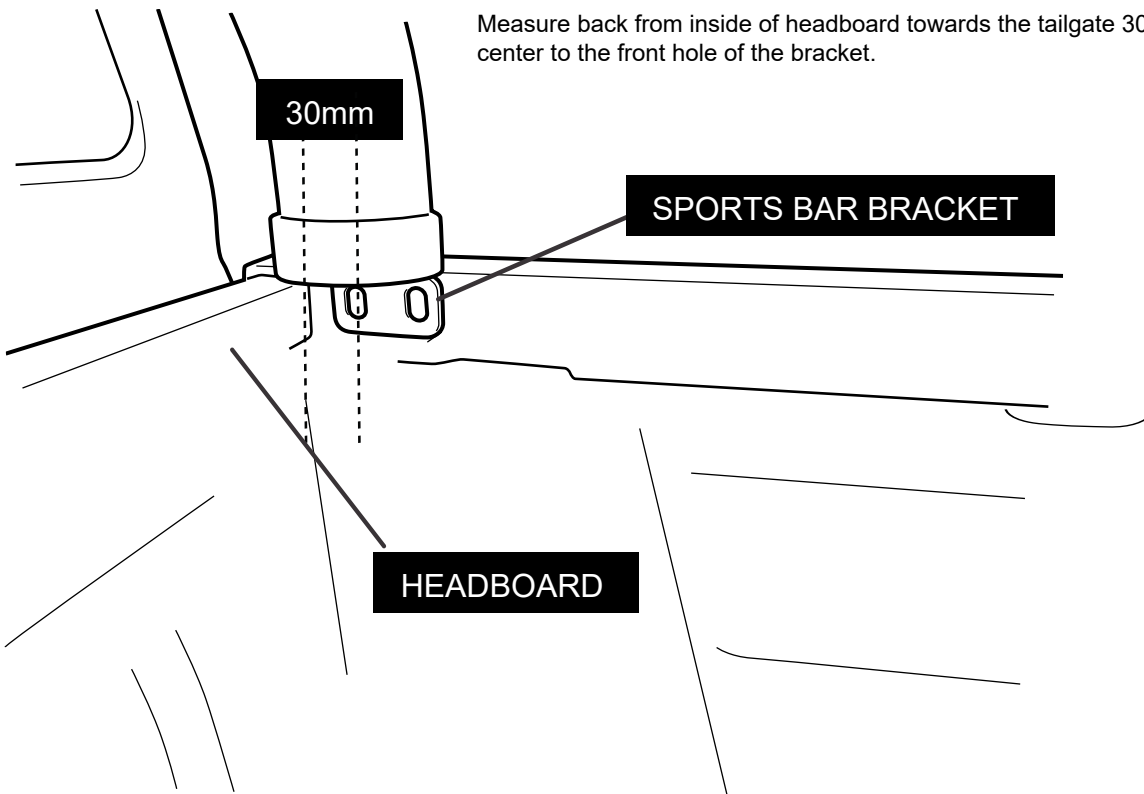

Repeat above steps to the other side.

Mark all points as indicated.

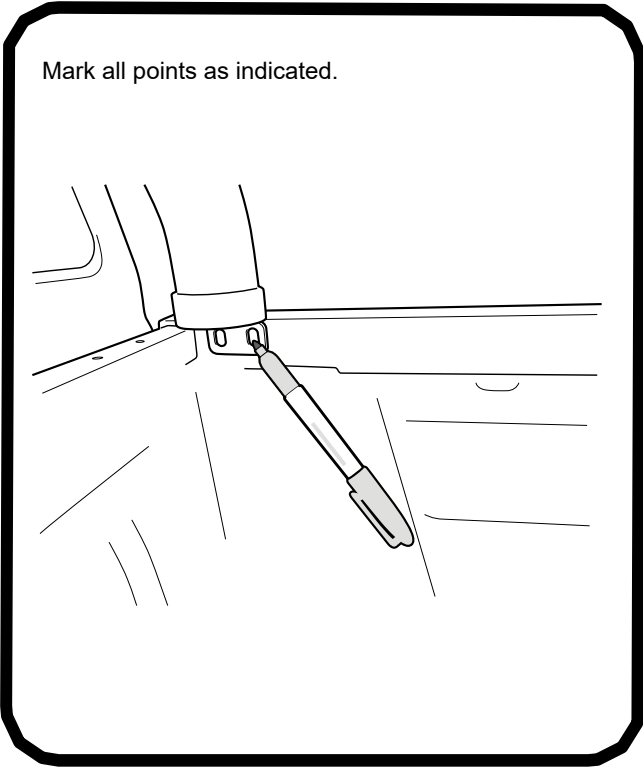

Mark all points as indicated.

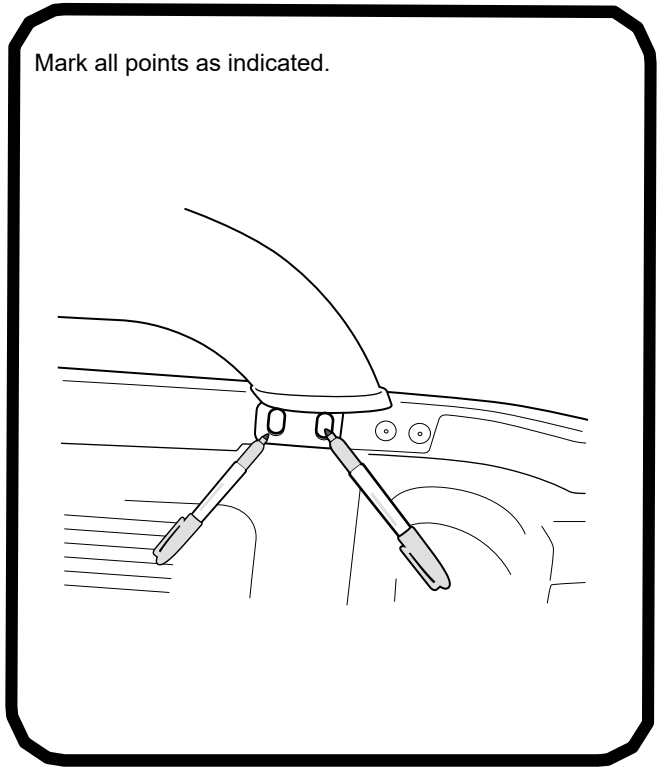

Repeat above steps to the other side.

Drill all marked locations to 12mm.

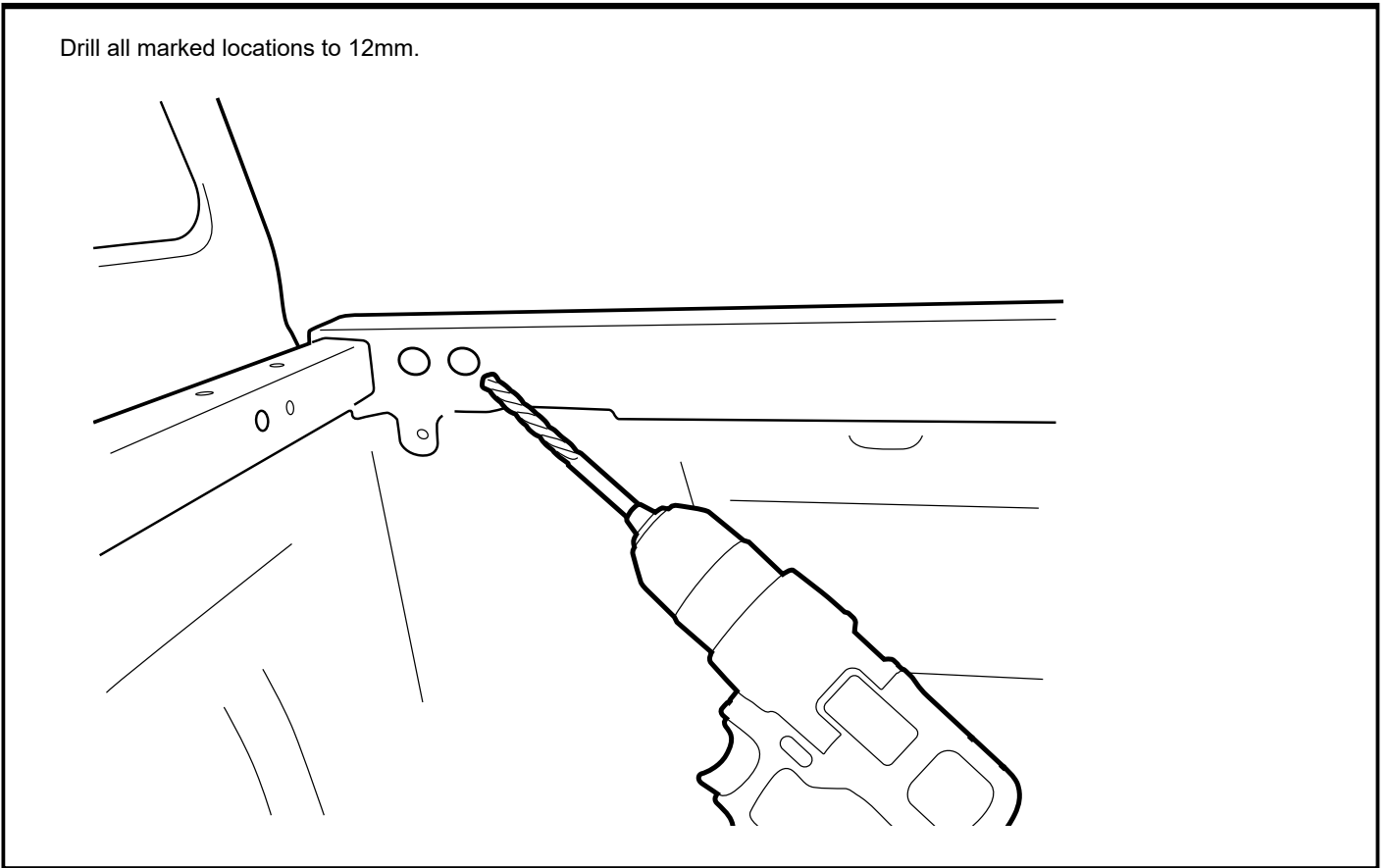

Install the rivet nuts to all pre-drilled holes.

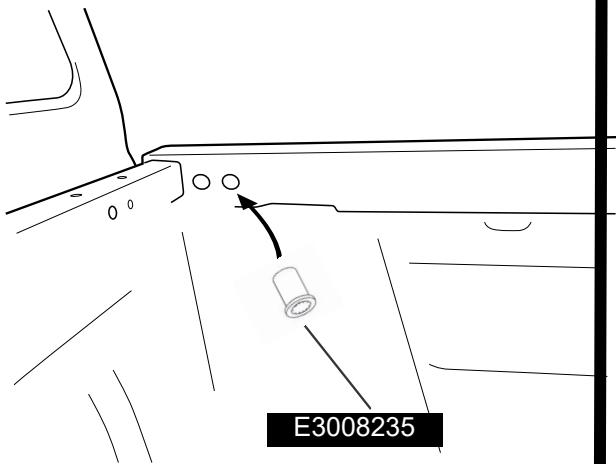

Fasten into place by using M8 hex flange bolt.

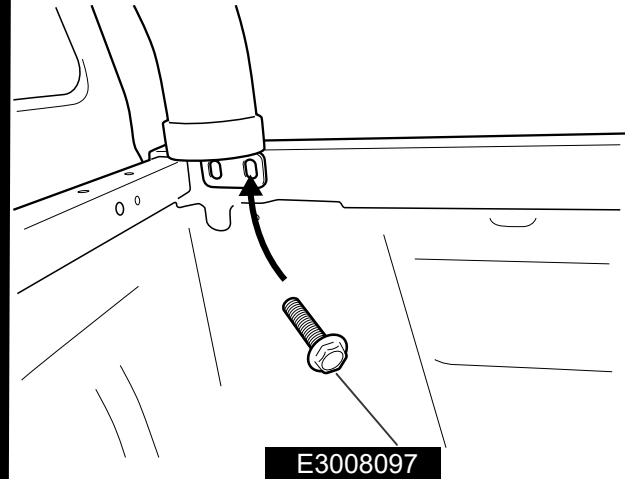

1. Remove passenger side tail light.
2. Route Armour bar wiring from front leg of tube towards passenger side taillight.

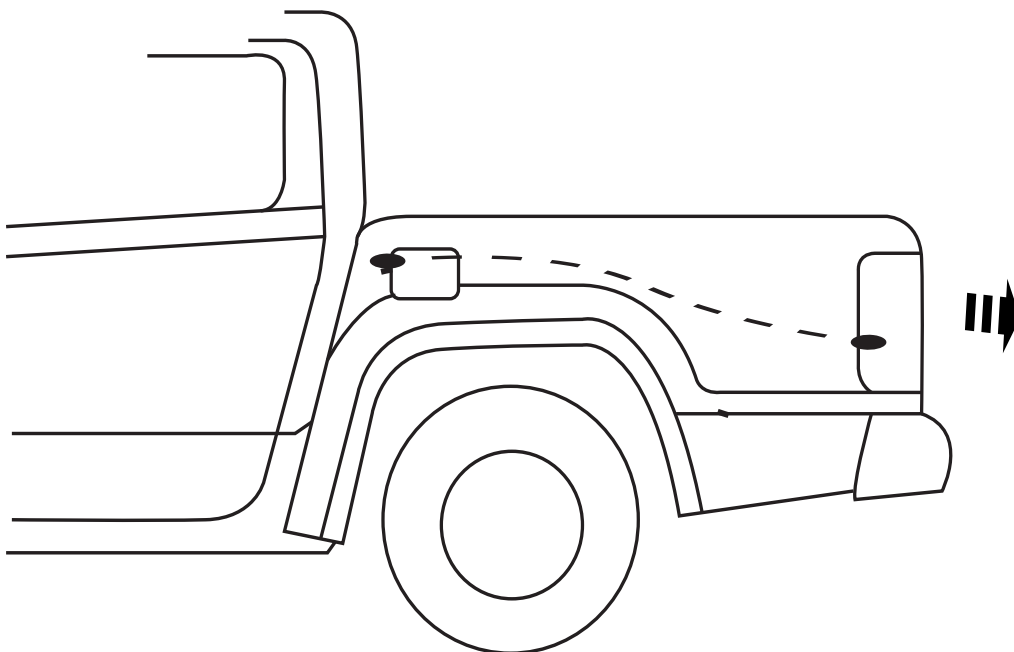

1. Locate vehicle brake light signals with a test light.
2. Attach scotch clamps provided to brake light signal wires.
3. Crimp accordingly.
4. Plug female connectors to male scotch clamp.

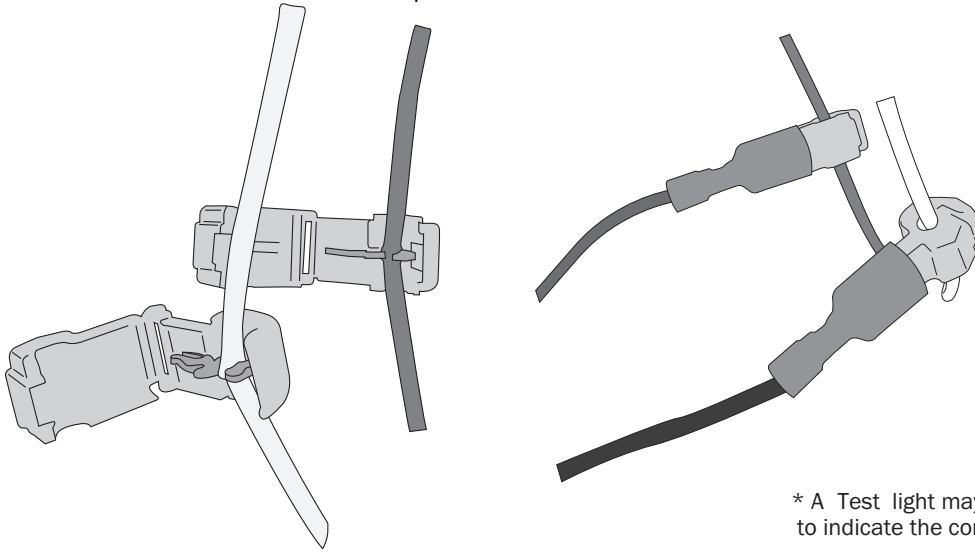

* A Test light may be needed to indicate the correct wires.

Connect Armour bar plug to patch plug connected to brake light signal Wires.

